

# GODREJ NURTURE

SECTOR 150, NOIDA

---

#PlayandGrow

---

 | **PROPERTIES**



THOUGHTFULLY  
DESIGNED HOMES  
WHERE YOUR KIDS CAN  
**#PLAYANDGROW**



STRATEGICALLY  
LOCATED



SECURED  
ADDRESS



THOUGHTFULLY  
DESIGNED



#PLAYANDGROW



**DND Expressway**

IGI Airport

Gautam Buddha Park

Radisson Blu

Atta Market

Noida Golf Course

**FNG Expressway\***

Hind on River

Wipro

Honda

LG

Moserbaer

Mahamaya Flyover

Amity University

Jaypee Hospital

**Noida-Greater Noida Expressway**

Advant Navis Business Park

International Standard Cricket Stadium

18-Hole Golf Course

Kailash Hospital

**GODREJ GOLF LINKS**

Pari Chowk

DPS

Genesis Global School

IT HUB-Sector 135

Knowledge Park

India Exposition Mart

DPS

Radisson

Max

Grand Venice Mall

**Yamuna River**

**LEGENDS**

School/College/Institute

F1 International Circuit

Landmark

Mall

Commercial Complex

Temple

Metro under Construction

Metro Line

Hospital

Park

Expressway

\* Construction in Progress

**Faridabad**

Shriram Millennium School

Shaheed Bhagat Singh Park

**GODREJ NURTURE**

World Trade Center Noida

Towards Proposed Airport

**LOCATION MAP**

Source: Google Maps. Maps not to scale.





## UPCOMING METRO STATION SECTOR 148 IN CLOSE PROXIMITY\*

\*Source: <https://timesofindia.indiatimes.com/city/noida/noida-metro-extends-trial-run-to-alpha-ii/articleshow/62762365.cms>

Stock image is for representative purposes





## CLOSE PROXIMITY TO PROPOSED INTERNATIONAL AIRPORT AT JEWAR\*

Stock image is for representative purpose.

\*Source: <https://www.financialexpress.com/photos/business-gallery/734988/jewar-airport-news-2017-greater-noida-5-things-to-know-new-international-airport-uttar-pradesh-jewar-airport-map/>





## WELL-CONNECTED TO 3 MAJOR EXPRESSWAYS\*

NOIDA – GREATER NOIDA EXPRESSWAY, YAMUNA EXPRESSWAY AND EASTERN PERIPHERAL EXPRESSWAY

Stock image is for representative purpose.

\*Source: <https://indianexpress.com/article/cities/delhi/noidagreater-noida-expressway-where-safety-takes-a-backseat/>





# SOCIAL INFRASTRUCTURE

## A PLACE THAT HAS EVERYTHING

---



### SCHOOLS

- Amity International School, Sec 44 Noida
- Lotus Valley International School, Sec 126 Noida
- DPS, Sec 132 Noida
- Somerville International School, Sec 132 Noida
- Shriram Millennium School, Sec 135 Noida



### COLLEGES & TECHNICAL INSTITUTES

- Amity University, Sec 125 Noida
- Galgotia University, Knowledge Park, Gr. Noida
- Sharda University, Knowledge Park, Gr. Noida



### HOSPITALS & HEALTHCARE SETUPS

- Fortis, Sec 62 Noida
- Kailash Hospita, Knowledge Park, Gr. Noida
- Max Hospital, Gr. Noida



### CORPORATES

- Honda,
- Moser Baer
- LG
- Wipro Technologies
- Ansal IT City and Parks Ltd.
- NIIT Technologies Ltd.
- KPMG
- Advent Business Park
- Accenture





ARTIST'S IMPRESSION. TO BE DEVELOPED BY THIRD PARTY.

## INTERNATIONAL STANDARD CRICKET ACADEMY\*



ARTIST'S IMPRESSION. TO BE DEVELOPED BY THIRD PARTY.



## 9 HOLE GOLF COURSE\* & GOLF CLUB\*

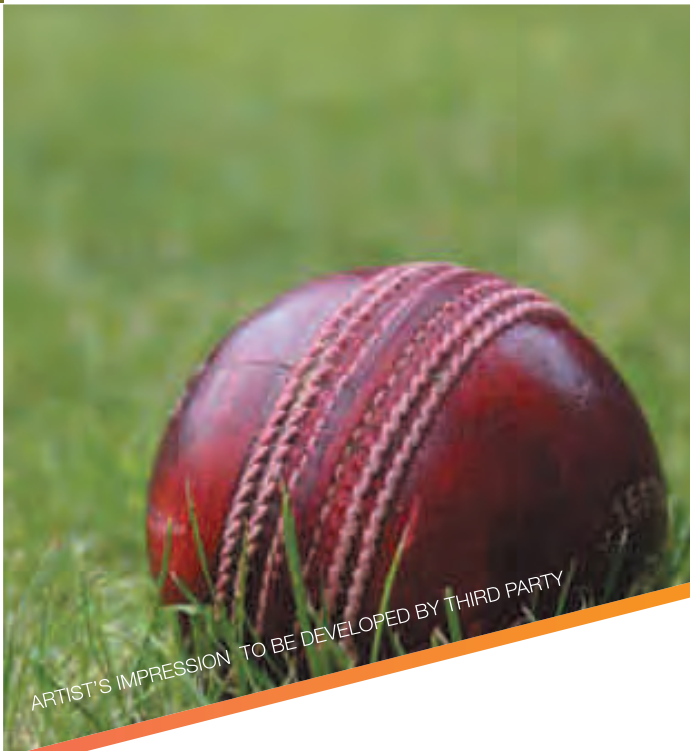

ARTIST'S IMPRESSION TO BE DEVELOPED BY THIRD PARTY



## EXPANSIVE RETAIL\* & ENTERTAINMENT CENTRE\*

# MEGA SPORTS CITY

\*Facilities provided as a part of approved master plan for sports city sc - 02 Do not form a part of godrej nurture and these facilities are not To be developed by the developer

# A SECURED ADDRESS



CITY LEVEL  
SECURITY



NEIGHBORHOOD  
SECURITY



PERIMETER  
SECURITY



PROJECT LEVEL  
SECURITY



UNIT LEVEL  
SECURITY

**EMBRACE A LIFE THAT COMES  
WITH 5-TIER SECURITY NET**





## CITY LEVEL SECURITY\*



Personal Bike Escort



## NEIGHBORHOOD SECURITY\*\*



Shuttle Service



## PERIMETER SECURITY



Dog Patrolling



Face detector



Under Vehicle scanner



## PROJECT LEVEL SECURITY



Round The Clock CCTV Surveillance



## UNIT LEVEL SECURITY

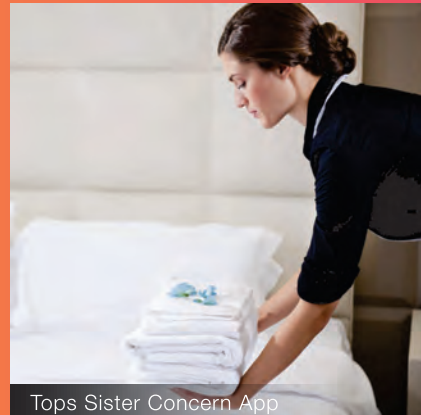

Tops Sister Concern App



RFID Monitoring



Panic Alarm Button

\*To be Pre booked from Godrej Nurture to any point in Delhi/ncr  
\*\*Godrej nurture to select destinations during pre defined time slots  
Stock images for representative purpose.



**THOUGHTFULLY DESIGNED**





# LANDSCAPE INSPIRED BY ELEMENTS OF NATURE

A: DIGITAL PLAZA | B: MOUND GARDEN | C: HERB GARDEN | D: GARDEN OF PRECEPTION | E: CHESS PLAZA | F: COLOUR GARDEN | G: GARDEN OF SENSES  
H: GARDEN OF VITALITY | I: BUTTERFLY GARDEN | J: AROMATIC GARDEN | K: REFLEXOLOGY | L: YOGA/ MEDITATION LAWN | M: CELEBRATION LAWN | N: PARTY LAWN





Artist's impression. Not an actual site photograph.





View from Godrej NURTURE Iconic Tower, overlooking Godrej NEST  
Artist's impression. Not an actual site photograph.



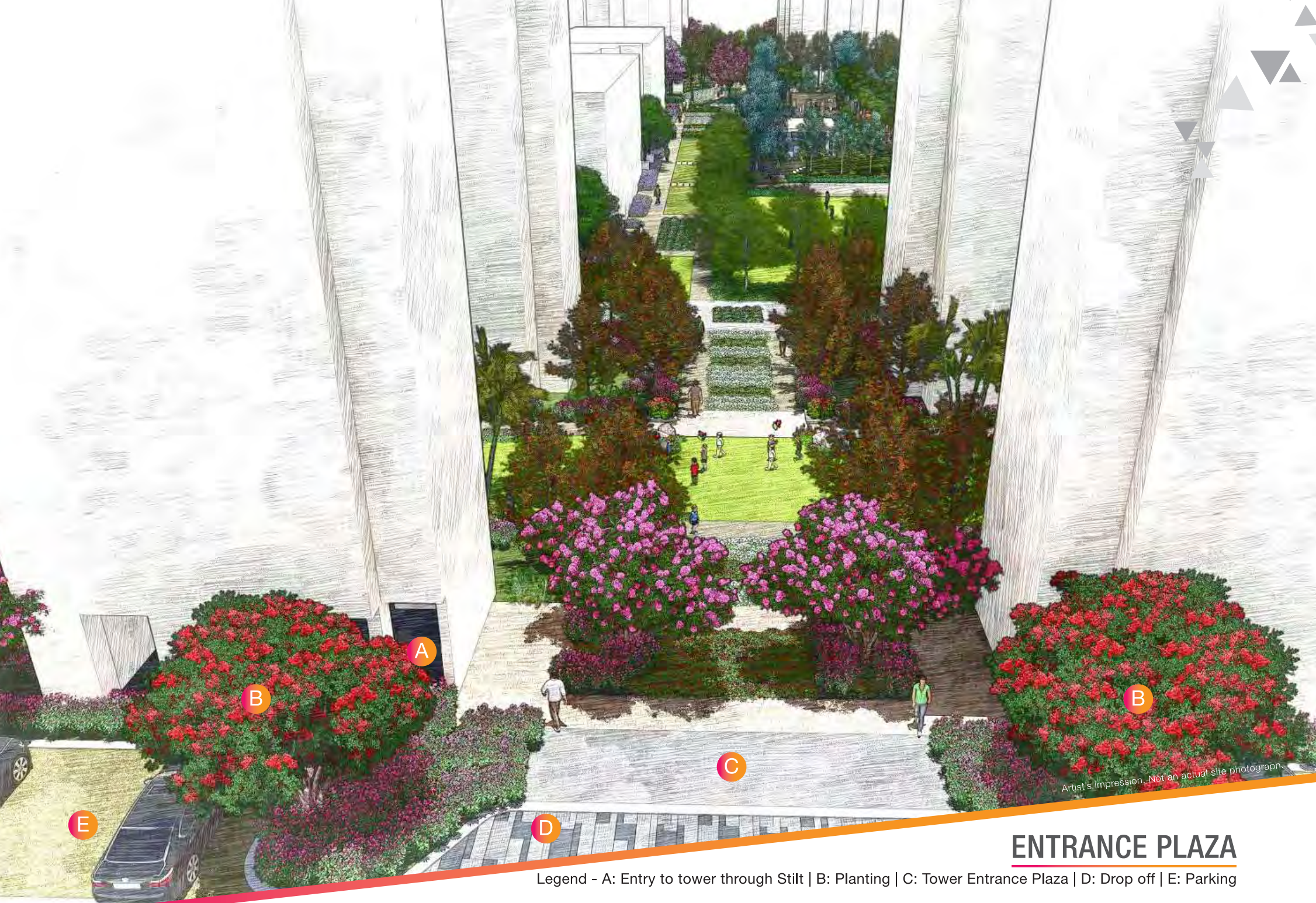

Artist's impression. Not an actual site photograph.

# ENTRANCE PLAZA

Legend - A: Entry to tower through Stilt | B: Planting | C: Tower Entrance Plaza | D: Drop off | E: Parking





Artistic Impression. Not an actual site photograph.

## DIGITAL PLAZA AND MOUND GARDEN

Legend - A: Digital Plaza | B: Stepping Stones | C: Mound Garden





Artist's impression. Not an actual site photograph.

# HERB GARDEN

Legend - A: Herb Garden | B: Tower Entrance Plaza | C: Contemplation Pavilions | D: Outdoor Gym





Artist's impression. Not an actual site photograph.

# SCIENCE PARK AND CHESS GARDEN

Legend - A: Kids Play Area | B: Swimming Pool Zone | C: Colour Garden | D: Chess Garden | E: Maze Garden | F: Science Park





Artist's impression. Not an actual site photograph.

# COLOUR GARDEN

Legend - A: Colour Garden





Artist's impression. Not an actual site photograph.

# CHESS GARDEN

Legend - A: Chess Garden | B: Entry to Tower Stilt | C: Maze Garden | D: Garden of Perception





Artist's Impression. Not an actual site photograph.

## GARDEN OF SENSES





Artist's impression. Not an actual site photograph.

## GARDEN OF VITALITY





Artist's Impression. Not an actual site photograph.

# BUTTERFLY GARDEN



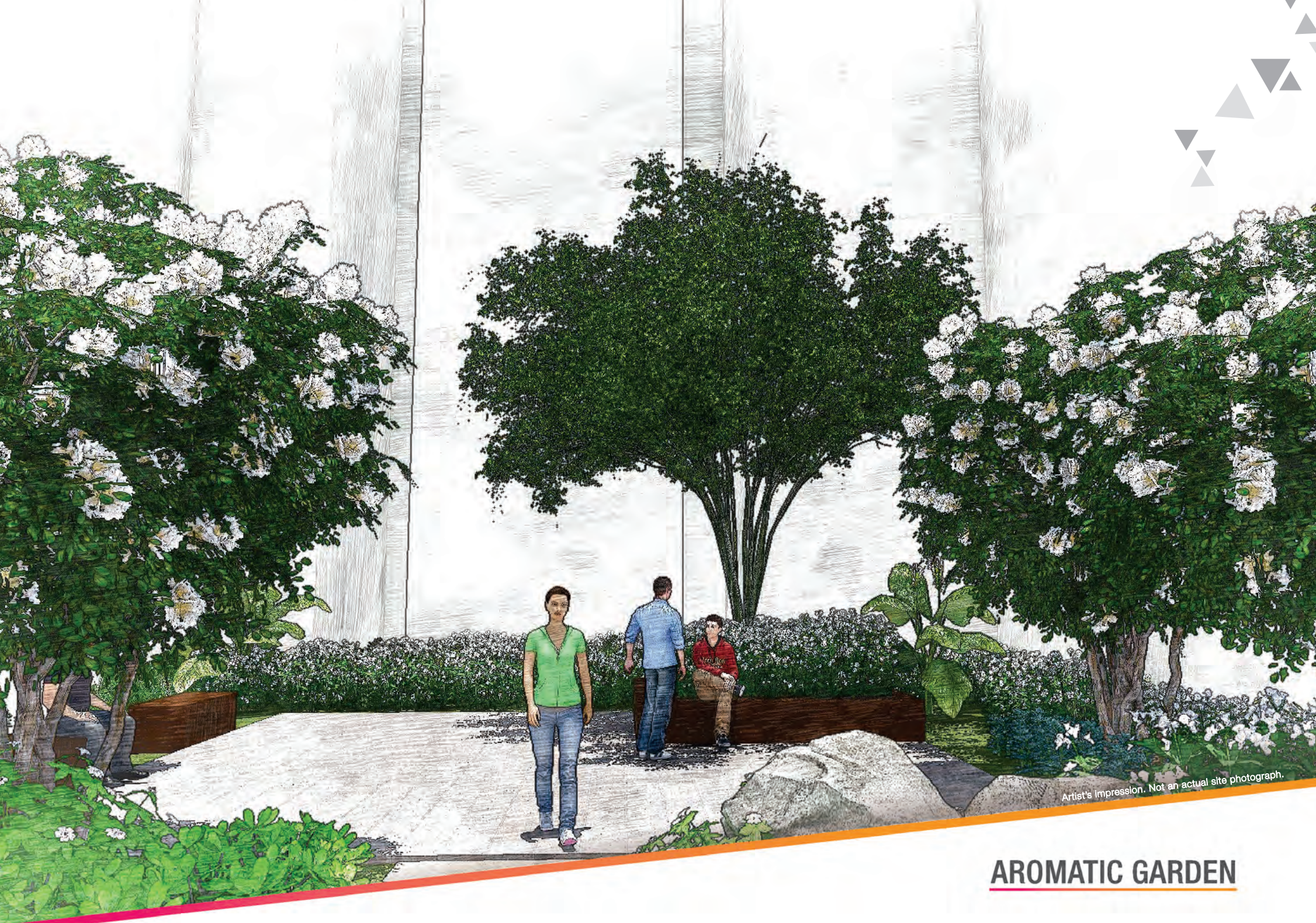

Artist's Impression. Not an actual site photograph.

## AROMATIC GARDEN





Artist's Impression. Not an actual site photograph.



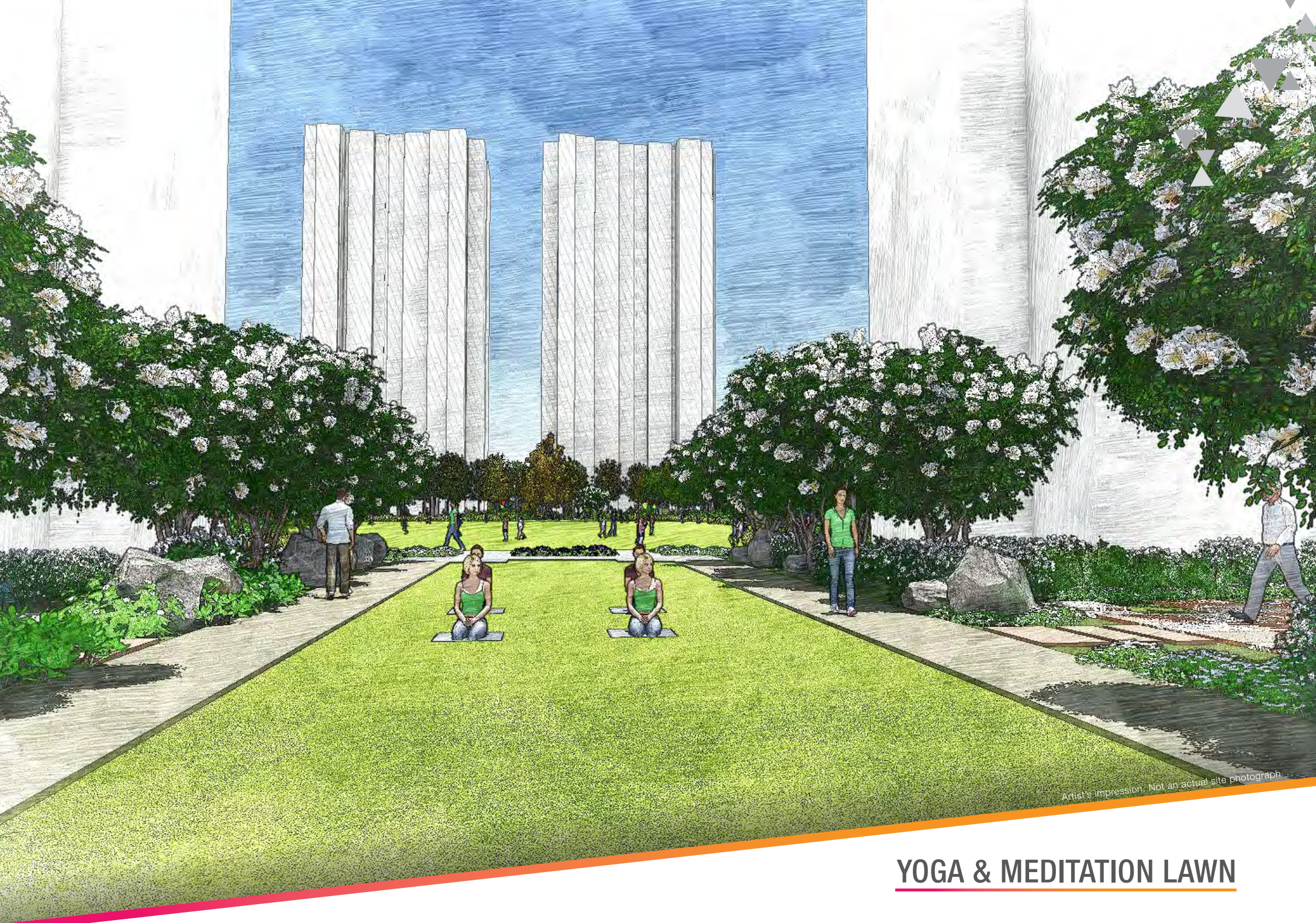

Artist's impression. Not an actual site photograph.

## YOGA & MEDITATION LAWN





Artist's impression. Not an actual site photograph.

## **CELEBRATION LAWN**

Legend - A: Celebration Lawn | B: Amphitheatre | C: Yoga & Meditation Lawn | D: Pool Deck





Artist's impression. Not an actual site photograph.

# PARTY LAWN





Artist's impression. Not an actual site photograph.

## SWIMMING POOL ZONE

Legend - A: Pool Deck | B: Surprise Fountain | C: Kids Pool | D: Swimming Pool | E: Jacuzzi | F: Floating Pavilion



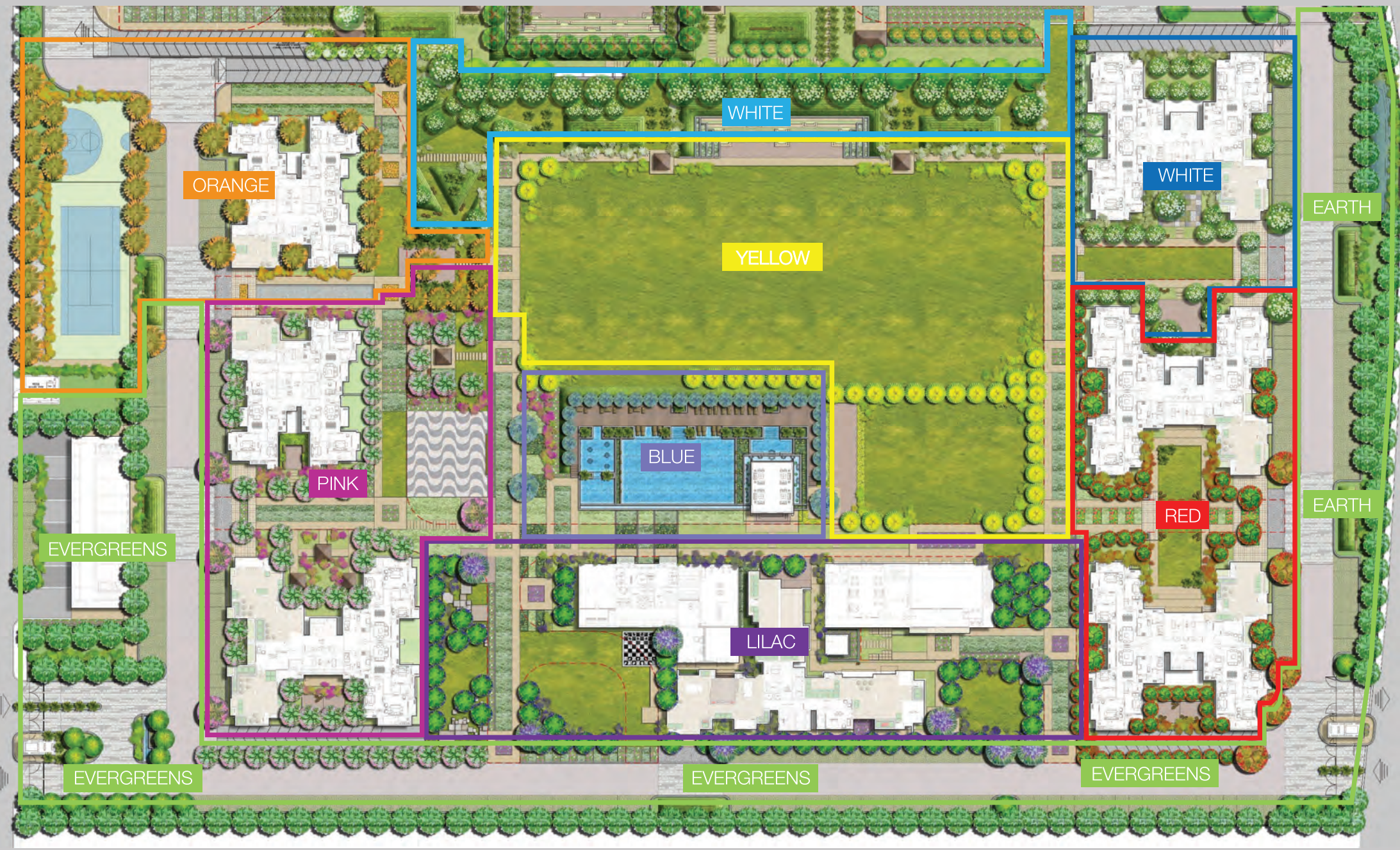

# PLANTING INTENT





## HOMES THAT NURTURE YOUR LOVED ONE'S DEVELOPMENT

Godrej Nurture is a project that revolves around every aspect of your child's growth, development and safety by all means. The entire development consists of avenues and facilities that are required for a child's advancement right from their birth till their teen ages.







Physical  
Growth



Cognitive  
Growth

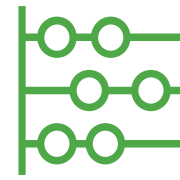

Social &  
Emotional  
Awareness







TENNIS



SQUASH



HALF BASKETBALL COURT



SKATING PITCH



SWIMMING POOL



CRICKET PITCH



MULTIPLE DANCE CLASSES



NET CLIMBING



ROCK CLIMBING



MARTIAL ARTS

# PHYSICAL GROWTH





ART AND CRAFT

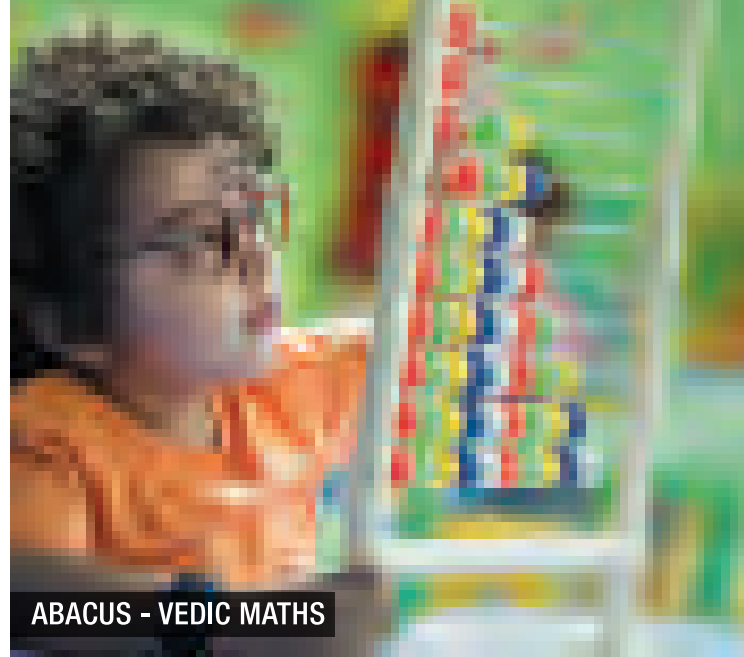

ABACUS - VEDIC MATHS



DRAMATICS



LIBRARY



STORY TELLING



CREATIVE WRITING AND LANGUAGE CLASSES

# COGNITIVE GROWTH





MUSIC ROOM



CRÈCHE



MINIPLEX



INDOOR PLAY AREA



VIRTUAL GAMING ZONE



YOGA & MEDITATION AREA

## SOCIAL & EMOTIONAL AWARENESS



A cluster of small, dark orange triangles of various sizes and orientations, arranged in a roughly triangular shape pointing towards the top right corner of the page.

**SAFE HOMES  
FOR YOUR LOVED ONES**





## ROUNDED EDGES OF WALLS

Stock Image is for representative purpose.





Stock image is for representative purposes

## MOLDED SKIRTING





**COVERED SHOCKPROOF  
SWITCH BOARDS AT HOMES**

Stock image is for representative purpose.





**CHILD SAFE WINDOWS WITH  
GRILLED AND WITH MOSQUITO NETS**

---

*Stock image for representativ purpose.*





## KIDS SAFE RAILINGS

Stock image is for representative purpose.





Stock image is for representative purpose.

## LATCHES ON TOILET SEAT COVERS





## **CHILD SAFE LOCKS ON KITCHEN CABINETS**

---

Stock image is for representative purpose.





**DOOR HINGES TO ENSURE  
DOOR CLOSSES SLOWLY**

Stock image is for representative purpose.





**CHILD LOCK ON  
DOORS WITH SENSORS**

---

Stock image is for representative purpose.





Stock image is for representative purpose.

**LOW / NO VOC PAINTS**





**HANDRAILS INSIDE BATHROOMS**

Stock image is for representative purpose.





## **ANTI-SKID TILES IN BATHROOMS & TERRACES**

Stock image is for representative purpose.



Unit Type	Carpet Area (Sq. M.)	Exclusive Area (Sq. M.)	Total Area (Sq M)
<b>NURTURE</b>			
2BHK	69	14	83
3RHK	83.30	18.7	102
3BHK + Utility	113.60	23.54	137.14
<b>ICONIC</b>			
Iconic - 3BHK + Utility	126.40	26.50	152.90
Iconic 4BHK + Utility	150.36	28.70	179.06
Iconic 4BHK + Utility + Family Lounge	169.20	32	201.20

**PRODUCT DETAILS**  
**UNIT CONFIGURATION**





Site Address: Plot No. SC-02/ H & I, Sec 150, Noida

RERA Registration No. UPRERAPRJ17861, website- <http://up-rera.in>, Building Plan dated 30.09.2016 bearing No. IV-1490/929.  
This is not an offer, an invitation to offer and/or commitment of any nature. Recipients are advised to apprise themselves of the necessary & relevant information of the project prior to making any purchase decisions. The designs, dimensions, cost, facilities, plans, furniture, accessories, paintings, items, electronic goods, additional fittings/fixtures, decorative items, false ceiling including finishing materials, specifications, shades, sizes, colour of the finishing materials and other details shown in the images are only indicative in nature and are only for the purpose of illustrating/indicating a possible layout and do not form part of the standard specifications/amenities/services to be provided. All specifications of the unit shall be as per the final agreement between the Parties. The present project is being developed by Brick Rise Developers Pvt. Ltd. (A subsidiary of Lotus Greens Constructions Pvt. Ltd.) who has appointed Godrej Properties Limited as the Development Manager for the same. The developer has mortgaged the project land with IndusInd Bank Ltd and NOC shall be provided as and when needed. \*These services will be provided free of cost only for a period of 2 (two) years from the date of possession, T & C Apply, Official website for the project is [www.godrejproperties.com](http://www.godrejproperties.com). Please do not rely on any other website.